

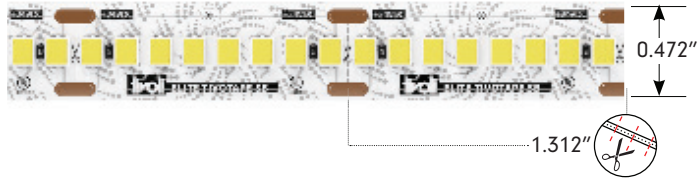

ELITE

ELITE offers a rounded solution with overall high CRI values, 4 oz. copper trace for consistency, and low bin tolerance.



| PRODUCT CODE | INTENSITY | INSTALL | LED COLOR | VOLTAGE |
|-----------------------|--|------------|--|-------------|
| TPLE | | I | | 24 |
| TPLE = TivoTape ELITE | SB = Standard Brightness HO = High Output VHO = Very High Output | I = Indoor | 22 = 2200K 24 = 2400K 27 = 2700K 30 = 3000K 35 = 3500K 40 = 4000K 50 = 5000K | 24 = 24V DC |

Quick Spec

| Quick Data based on 4000K | | | |
|---------------------------|-----|-----|-----|
| Intensity | SB | HO | VHO |
| Lumens/ft | 378 | 549 | 819 |
| Efficacy (Lm/W) | 117 | 122 | 117 |
| CRI | 90+ | 90+ | 90+ |
| Measured Power W/ft | CF | CF | CF |
| Listed Power W/ft. | 3.2 | 4.5 | 7 |
| Max Run | 29' | 20' | 13' |



| Available CCTs |
|---|
| 2200K, 2400K, 2700K, 3000K, 3500K, 4000K, 5000K |

IP67 available for SB and HO only

| ADUL-series | | | | |
|-------------|-----|-----|-------|-----|
| D | DOT | DIN | DIN-X | DTV |
| • | • | • | • | • |

Non-Dimming (D), 0-10V (DOT), DMX (DIN), DMX Multi Address (DIN-X), Flicker Free TV (DTV)

| Infinity |
|----------|
| • |

Universal input: 100V- 277V AC
All-In-One dimming protocol: ELV, MLV, 0-10V, TRIAC, PWM



DEFINE- Standard Brightness

Standard Brightness TivoTape is durable and flexible with a 3 oz. copper trace for excellent heat dissipation and consistent color through-out recommended maximum run length.



| PRODUCT CODE | INTENSITY | INSTALL | LED COLOR | VOLTAGE |
|-------------------------------|--------------------------|------------|--|-------------|
| TPLD | SB | I | | 24 |
| TPLD = TivoTape DEFINE 90+CRI | SB = Standard Brightness | I = Indoor | 22 = 2200K 24 = 2400K 27 = 2700K 30 = 3000K 35 = 3500K 40 = 4000K 50 = 5000K | 24 = 24V DC |

Quick Spec

| Quick Data based on 3000K | |
|---------------------------|-----|
| Intensity | SB |
| Lumens/ft | 227 |
| Efficacy (Lm/W) | 81 |
| CRI | 92 |
| Measured Power W/ft | CF |
| Listed Power W/ft. | 3 |
| Max Run | 32' |



| Available CCTs |
|---|
| 2200K, 2400K, 2700K, 3000K, 3500K, 4000K, 5000K |

IP67 Outdoor Rated Available

| ADUL-series | | | | |
|-------------|-----|-----|-------|-----|
| D | DOT | DIN | DIN-X | DTV |
| • | • | • | • | • |

Non-Dimming (D), 0-10V (DOT), DMX (DIN), DMX Multi Address (DIN-X), Flicker Free TV (DTV)

| Infinity |
|----------|
| • |

Universal input: 100V- 277V AC
All-In-One dimming protocol: ELV, MLV, 0-10V, TRIAC, PWM



DEFINE- High Output

High Output TivoTape is durable and flexible with a 3 oz. copper trace for excellent heat dissipation and consistent color through-out recommended maximum run length.



| PRODUCT CODE | INTENSITY | INSTALL | LED COLOR | VOLTAGE |
|-------------------------------|------------------|------------|--|-------------|
| TPLD | HO | I | | 24 |
| TPLD = TivoTape DEFINE 90+CRI | HO = High Output | I = Indoor | 22 = 2200K 24 = 2400K 27 = 2700K 30 = 3000K 35 = 3500K 40 = 4000K 50 = 5000K | 24 = 24V DC |

Quick Spec

| Quick Data based on | |
|---------------------|-----|
| Intensity | HO |
| Lumens/ft | 393 |
| Efficacy (Lm/W) | 81 |
| CRI | 93 |
| Measured Power W/ft | CF |
| Listed Power W/ft. | 4.4 |
| Max Run | 21' |



| Available CCTs |
|---|
| 2200K, 2400K, 2700K, 3000K, 3500K, 4000K, 5000K |

IP67 Outdoor Rated Available

| ADUL-series | | | | |
|-------------|-----|-----|-------|-----|
| D | DOT | DIN | DIN-X | DTV |
| • | • | • | • | • |

Non-Dimming (D), 0-10V (DOT), DMX (DIN), DMX Multi Address (DIN-X), Flicker Free TV (DTV)

| Infinity |
|----------|
| • |

Universal input: 100V- 277V AC
All-In-One dimming protocol: ELV, MLV, 0-10V, TRIAC, PWM



DEFINE - Low Brightness

Low Brightness TivoTape produces a low lumen output with large maximum runs. Multiple color options are available with 90+ CRI.

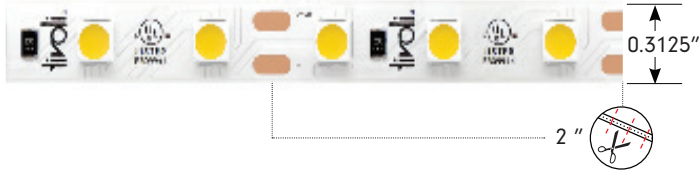

| PRODUCT CODE | INTENSITY | INSTALL | LED COLOR | VOLTAGE |
|----------------------------------|---------------------|------------|--|--------------------|
| TPLD | LB | I | 27 = 2700K 30 = 3000K 40 = 4000K 62 = 6200K AM = Amber RD = Red BL = Blue | 12 = 12V DC |
| TPLD = TivoTape DEFINE 90+ CRI** | LB = Low Brightness | I = Indoor | | |

Quick Spec

| Quick Data based on 2700K | |
|---------------------------|------|
| Intensity | LB |
| Lumens/ft | 120 |
| Efficacy (Lm/W) | 82 |
| CRI | 92 |
| Measured Power W/ft | CF |
| Listed Power W/ft. | 1.46 |
| Max Run | 41' |

| ADUL-series | | | | |
|-------------|-----|-----|-------|-----|
| D | DOT | DIN | DIN-X | DTV |
| * | * | * | * | |

Non-Dimming (D), 0-10V (DOT), DMX (DIN), DMX Multi Address (DIN-X), Flicker Free TV (DTV)

| Infinity | | | | |
|----------|--|--|--|--|
| * | | | | |

Universal input: 100V- 277V AC
All-In-One dimming protocol: ELV, MLV, 0-10V, TRIAC, PWM



| Available CCTs | |
|-----------------------|--|
| 22700K, 3000K, 4000K, | |
| 6200K, Amber, Red, | |
| Blue | |

IP67 Outdoor Rated Available



DEFINE - Side Emitting

Side Emitting is used for certain applications that call for a unique design challenge that needs a specific LED package orientation.



| PRODUCT CODE | INTENSITY | INSTALL | LED COLOR | VOLTAGE |
|--------------------------------------|--------------------------|------------|--|--------------------|
| TPLS | SB | I | 27 = 2700K 30 = 3000K 35 = 3500K 40 = 4000K 50 = 5000K 65 = 6500K | 24 = 24V DC |
| TPLS = TivoTape Define Side Emitting | SB = Standard Brightness | I = Indoor | | |

Quick Spec

| Quick Data based on 2700K | |
|---------------------------|------|
| Intensity | SE |
| Lumens/ft | 226 |
| Efficacy (Lm/W) | 75.3 |
| CRI | 90+ |
| Measured Power W/ft | CF |
| Listed Power W/ft. | 3.6 |
| Max Run | 32' |

| ADUL-series | | | | |
|-------------|-----|-----|-------|-----|
| D | DOT | DIN | DIN-X | DTV |
| * | * | * | * | * |

Non-Dimming (D), 0-10V (DOT), DMX (DIN), DMX Multi Address (DIN-X), Flicker Free TV (DTV)

| Infinity | | | | |
|----------|--|--|--|--|
| * | | | | |

Universal input: 100V- 277V AC
All-In-One dimming protocol: ELV, MLV, 0-10V, TRIAC, PWM



| Available CCTs | |
|----------------------|--|
| 2700K, 3000K, 3500K, | |
| 4000K, 5000K, 6500K, | |



Power Leads

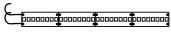

TPL-I-LEAD-2-C
LEAD/END
24" standard 2 conductor 18AWG lead wire
factory attached to one end of tape



TPL-I-LEAD-2-D
LEAD/LEAD
24" standard 2 conductor 18AWG lead wire
factory attached to both ends of tape

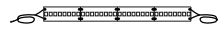

TPL-I-XEP-2
EXTRA LEAD WIRE
Additional factory attached 18AWG lead 2
wire to extend lengths of LEAD-C and LEAD-D
up to 20 ft. max
Sold per foot



TPL-I-CONN
18-22AWG BUTT CONNECTORS
Used to interconnect factory attached lead
wires.
Sold individually

Extrusion

Available Lens Type Compatible TivoTape

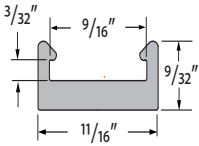

MCHAN-8-LP
Low profile NO LENS OPTION
clear polycarbonate, length 8'

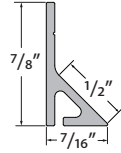

TPL-45-MCH-8-S
White PVC, 45° NO LENS length 8'

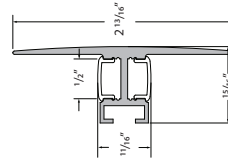

DWAR
DEWARE Anodized Aluminum Extrusion,
available in 6.5' lengths

Clear Opal Diffused

ELITE DEF SB DEF HO DEF LB

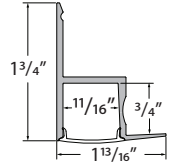

EDGE
EDGE Anodized Aluminum Extrusion,
available in 6.5' lengths

Opal

ELITE DEF SB DEF HO DEF LB

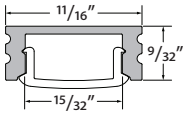

MINI
MINI Anodized Aluminum Extrusion,
available in 6.5' lengths

Opal

ELITE DEF SB DEF HO DEF LB

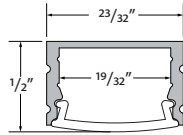

MOFT
MOFFETT Anodized Aluminum Extrusion,
available in 6.5' lengths

Clear Opal Diffused

ELITE DEF SB DEF HO DEF LB

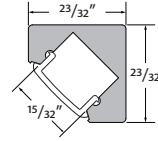

DYER
DYER Anodized Aluminum Extrusion,
available in 6.5' lengths

Opal

ELITE DEF SB DEF HO DEF LB

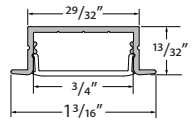

WRNR
WARNER Anodized Aluminum Extrusion,
available in 6.5' lengths

Opal

ELITE DEF SB DEF HO DEF LB

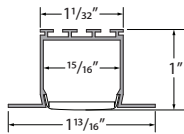

NOYS
NOYES Anodized Aluminum Extrusion,
available in 6.5' lengths

Clear Opal Diffused

ELITE DEF SB DEF HO DEF LB

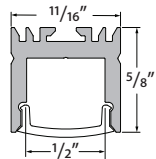

VALN
VALENCIA Anodized Aluminum Extrusion,
available in 6.5' lengths

Clear Opal Diffused

ELITE DEF SB DEF HO DEF LB

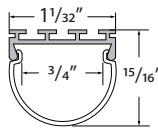

DOME
DOME Anodized Aluminum Extrusion,
available in 6.5' lengths

Opal

ELITE DEF SB DEF HO DEF LB

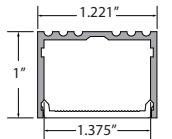

ALTN
ALTON Anodized Aluminum Extrusion,
available in 6.5' lengths

Clear Opal Diffused

ELITE DEF SB DEF HO DEF LB

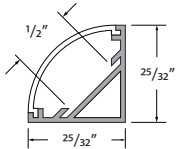

MRSL
MARSALA Anodized aluminum extrusion
available in 6.5' length

Clear Opal Diffused

ELITE DEF SB DEF HO DEF LB

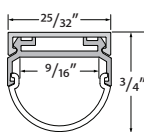

HRIZ
HORIZON Anodized aluminum extrusion
available in 6.5' length

Opal

ELITE DEF SB DEF HO DEF LB

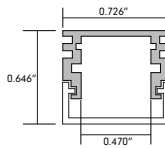

ASTR
ASTORIA Anodized aluminum extrusion
available in 6.5' length

Clear Diffused

ELITE DEF SB DEF HO DEF LB

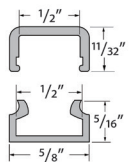

INF
INFINITY PC extrusion,
available in 8' lengths

Frosted Diffused

ELITE DEF SB DEF HO DEF LB

Power Supplies 24V

ELITE, DEFINE SB, DEFINE HO, DEFINE SE

INFINITY - MLV / ELV / 0-10V / PWM / TRIAC

| DESCRIPTION | CAT NO | APPLICATION | PRIMARY VOLTAGE | SECONDARY VOLTAGE | CIRCUIT BREAKERS | MAX LOAD | MIN LOAD | CIRCUIT CAPACITY |
|--|-------------------|---------------------|-----------------|-------------------|------------------|----------|----------|------------------|
| Infinity Series Class 2 Transformer | INF-J-30-1-1.3-24 | Indoor / Outdoor | 100 - 277V AC | 24V DC | 1 | 30W | 3W | 1.3A |
| | INF-J-60-1-2.5-24 | | | | 1 | 60W | 6W | 2.5A |
| | INF-J-96-1-4-24 | | | | 1 | 96W | 9W | 4A |
| | INF-J-192-2-4-24 | | | | 2 | 2x96W | 2x9W | 2x4A |
| | INF-J-288-3-4-24 | | | | 3 | 3x96W | 3x9W | 3x4A |

ADUL/ADNM - 0-10V DIMMING

| DESCRIPTION | CAT NO | APPLICATION | PRIMARY VOLTAGE | SECONDARY VOLTAGE | CIRCUIT BREAKERS | MAX LOAD | CIRCUIT CAPACITY |
|---|---------------------|---------------------|-------------------------|-------------------|------------------|----------|------------------|
| ADUL/ADNM Series Class 2 Transformer | ADNM-90-1-4-24-DOT | Indoor / Outdoor | 100-277V AC 50/60 HZ | 24V DC | 1 | 90W | 3.75A |
| | ADUL-120-1-4-24-DOT | | | | 1 | 96W | 4A |
| | ADUL-240-2-4-24-DOT | | | | 2 | 2x96W | 2x4A |
| | ADUL-320-3-4-24-DOT | | | | 3 | 3x96W | 3x4A |

ADUL/ADNM - NON DIMMING

| DESCRIPTION | CAT NO | APPLICATION | PRIMARY VOLTAGE | SECONDARY VOLTAGE | CIRCUIT BREAKERS | MAX LOAD | CIRCUIT CAPACITY |
|---|-------------------|---------------------|-------------------------|-------------------|------------------|----------|------------------|
| ADUL/ADNM Series Class 2 Transformer | ADNM-90-1-4-24-D | Indoor / Outdoor | 100-277V AC 50/60 HZ | 24V DC | 1 | 90W | 3.75A |
| | ADUL-120-1-4-24-D | | | | 1 | 96W | 4A |
| | ADUL-240-2-4-24-D | | | | 2 | 2x96W | 2x4A |
| | ADUL-320-3-4-24-D | | | | 3 | 3x96W | 3x4A |

ADUL/ADNM - DMX SINGLE ADDRESS

| DESCRIPTION | CAT NO | APPLICATION | PRIMARY VOLTAGE | SECONDARY VOLTAGE | CIRCUIT BREAKERS | MAX LOAD | CIRCUIT CAPACITY |
|---|---------------------|---------------------|-------------------------|-------------------|------------------|----------|------------------|
| ADUL/ADNM Series Class 2 Transformer | ADNM-90-1-4-24-DIN | Indoor / Outdoor | 100-277V AC 50/60 Hz | 24V DC | 1 | 90W | 3.75A |
| | ADUL-120-1-4-24-DIN | | | | 1 | 96W | 4A |
| | ADUL-240-2-4-24-DIN | | | | 2 | 2x96W | 2x4A |
| | ADUL-320-3-4-24-DIN | | | | 3 | 3x96W | 3x4A |

ADUL - DMX MULTI ADDRESS

| DESCRIPTION | CAT NO | APPLICATION | PRIMARY VOLTAGE | SECONDARY VOLTAGE | CIRCUIT BREAKERS | MAX LOAD | CIRCUIT CAPACITY |
|------------------------------------|-----------------------|---------------------|-------------------------|-------------------|------------------|----------|------------------|
| ADUL Series Class 2 Transformer | ADUL-240-2-4-24-DIN-2 | Indoor / Outdoor | 100-277V AC 50/60 Hz | 24V DC | 2 | 2x96W | 2x4A |
| | ADUL-320-3-4-24-DIN-3 | | | | 3 | 3x96W | 3x4A |

ADNM - DMX/DALI FLICKER-FREE FOR TV STUDIO

| DESCRIPTION | CAT NO | APPLICATION | PRIMARY VOLTAGE | SECONDARY VOLTAGE | CIRCUIT BREAKERS | MAX LOAD | CIRCUIT CAPACITY |
|------------------------------------|---------------------|---------------------|-------------------------|-------------------|------------------|----------|------------------|
| ADNM Series Class 2 Transformer | ADNM-120-1-4-24-DTV | Indoor / Outdoor | 100-277V AC 50/60 HZ | 24V DC | 1 | 1x96W | 1x4A |
| | ADNM-240-2-4-24-DTV | | | | 2 | 2x96W | 2x4A |
| | ADNM-320-3-4-24-DTV | | | | 3 | 3x96W | 3x4A |

Power Supplies 12V

DEFINE LB

INFINITY - MLV / ELV / 0-10V / PWM / TRIAC

| DESCRIPTION | CAT NO | APPLICATION | PRIMARY VOLTAGE | SECONDARY VOLTAGE | CIRCUIT BREAKERS | MAX LOAD | MIN LOAD | CIRCUIT CAPACITY |
|--|-------------------|---------------------|-----------------|-------------------|------------------|----------|----------|------------------|
| Infinity Series Class 2 Transformer | INF-J-30-1-1.3-24 | Indoor / Outdoor | 100 - 277V AC | 24V DC | 1 | 30W | 3W | 1.3A |
| | INF-J-60-1-2.5-24 | | | | 1 | 60W | 6W | 2.5A |
| | INF-J-96-1-4-24 | | | | 1 | 96W | 9W | 4A |
| | INF-J-192-2-4-24 | | | | 2 | 2x96W | 2x9W | 2x4A |
| | INF-J-288-3-4-24 | | | | 3 | 3x96W | 3X9W | 3x4A |

ADUL/ADNM - 0-10V DIMMING

| DESCRIPTION | CAT NO | APPLICATION | PRIMARY VOLTAGE | SECONDARY VOLTAGE | CIRCUIT BREAKERS | MAX LOAD | CIRCUIT CAPACITY |
|---|---------------------|---------------------|-------------------------|-------------------|------------------|----------|------------------|
| ADUL/ADNM Series Class 2 Transformer | ADNM-90-1-4-24-DOT | Indoor / Outdoor | 100-277V AC 50/60 HZ | 24V DC | 1 | 90W | 3.75A |
| | ADUL-120-1-4-24-DOT | | | | 1 | 96W | 4A |
| | ADUL-240-2-4-24-DOT | | | | 2 | 2x96W | 2x4A |
| | ADUL-320-3-4-24-DOT | | | | 3 | 3x96W | 3x4A |

ADUL - NON DIMMING

| DESCRIPTION | CAT NO | APPLICATION | PRIMARY VOLTAGE | SECONDARY VOLTAGE | CIRCUIT BREAKERS | MAX LOAD | CIRCUIT CAPACITY |
|------------------------------------|-------------------|------------------|-------------------------|-------------------|------------------|----------|------------------|
| ADUL Series Class 2 Transformer | ADUL-80-1-5-12-D | Indoor / Damp | 100-277V AC 50/60 HZ | 12V DC | 1 | 60W | 5A |
| | ADUL-150-2-5-12-D | | | | 2 | 2x60W | 2x5A |
| | ADUL-240-3-5-12-D | | | | 3 | 3x60W | 3x5A |
| | ADUL-320-4-5-12-D | | | | 4 | 4x60W | 4x5A |

ADUL - DMX MULTI ADDRESS

| DESCRIPTION | CAT NO | APPLICATION | PRIMARY VOLTAGE | SECONDARY VOLTAGE | CIRCUIT BREAKERS | MAX LOAD | CIRCUIT CAPACITY |
|------------------------------------|-----------------------|------------------|-------------------------|-------------------|------------------|----------|------------------|
| ADUL Series Class 2 Transformer | ADUL-150-2-5-12-DIN-2 | Indoor / Damp | 100-277V AC 50/60 HZ | 12V DC | 2 | 2x60W | 2x5A |
| | ADUL-240-3-5-12-DIN-3 | | | | 3 | 3x60W | 3x5A |
| | ADUL-320-4-5-12-DIN-4 | | | | 4 | 4x60W | 4x5A |

ADUL - DMX SINGLE ADDRESS

| DESCRIPTION | CAT NO | APPLICATION | PRIMARY VOLTAGE | SECONDARY VOLTAGE | CIRCUIT BREAKERS | MAX LOAD | CIRCUIT CAPACITY |
|------------------------------------|---------------------|------------------|-------------------------|-------------------|------------------|----------|------------------|
| ADUL Series Class 2 Transformer | ADUL-80-1-5-12-DIN | Indoor / Damp | 100-277V AC 50/60 HZ | 12V DC | 1 | 60W | 5A |
| | ADUL-150-2-5-12-DIN | | | | 2 | 2x60W | 2x5A |
| | ADUL-240-3-5-12-DIN | | | | 3 | 3x60W | 3x5A |

In-Wall DMX Control



TVOQ-1-WH
White



TVOQ-10-XX-7
XX = BK (Black), WH (White)



TVOQ-2-BK
Black

Dimmers

DIMMING - 0-10V

| DESCRIPTION | CAT NO | APPLICATION | INPUT VOLTAGE | OUTPUT VOLTAGE | MAX LOAD |
|--------------|------------|-------------|---------------|----------------|-------------------------------|
| 0-10V Dimmer | DIM-LD-010 | Indoor | 12V/24V DC | 12V/24V DC | 30 mA max. output (sink only) |

DIMMING - MLV

| DESCRIPTION | CAT NO | APPLICATION | INPUT VOLTAGE | OUTPUT VOLTAGE | MAX LOAD |
|-------------|--------|-------------|---------------|----------------|----------|
| MLV Dimmer | N-600 | Indoor | 120V AC | 120V AC | 450W |
| | N-1000 | | | | 800W |
| | N-1500 | | | | 1200W |
| | D-600 | | | | 450W |
| | M-600 | | | | 450W |
| | M-1000 | | | | 800W |

DIMMING - ELV

| DESCRIPTION | CAT NO | APPLICATION | INPUT VOLTAGE | OUTPUT VOLTAGE | MAX LOAD |
|-------------|--------|-------------|---------------|----------------|----------|
| ELV Dimmer | ME-600 | Indoor | 120V AC | 120V AC | 450W |
| | DE-300 | | | | 300W |